



We offer a design service
to help choose and
position your furniture.



THE
UNFITTED
KITCHEN CO.

Designed by Johnny Grey Studios

MODULAR CABINETRY

MIX AND MATCH WITH STYLE

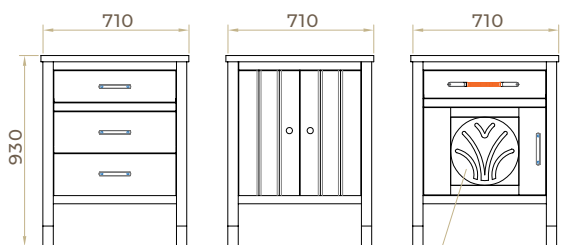

Alternative Doors

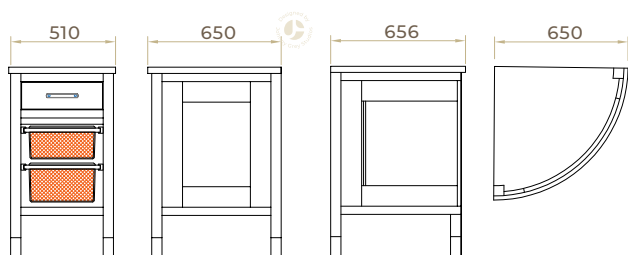

Side

Corner Base

Unfitted kitchens use furniture for planning by bringing together two simple elements.

Hero, or tall freestanding, pieces of furniture form the key features. These are complemented with modular base and storage cupboards which come in a range of dimensions to best fit walls and alcoves.

Modular base cabinets are flexible and can fit into awkward spaces. You can choose a range of sizes to build a long or short continuous cabinet. **1200mm is the widest. The 800mm width offers a double door cabinet. 600mm wide comes with a door and drawer, willow baskets or a single cupboard; 400mm likewise.**

Appliances can be either purchased as freestanding or be included in the hero and modular pieces, depending on the height required. For example, the oven and storage cabinet is a hero piece, the dishwasher base module works with a dishwasher drawer, and the raised height dishwasher cabinet houses a standard height appliance for ergonomic advantage.

The base cabinets provide the platform for work surfaces, which come in a variety of materials: composite stone, concrete, solid, end-grain, timber strips in oak or hardwood planks in environmentally friendly iroko.

You can plan your work surfaces to facilitate targeted kitchen activities. We call this idea **'dedicated work surfaces'** and it makes the best possible use of space.